

Commercial Office Space **NOW FOR LEASE**

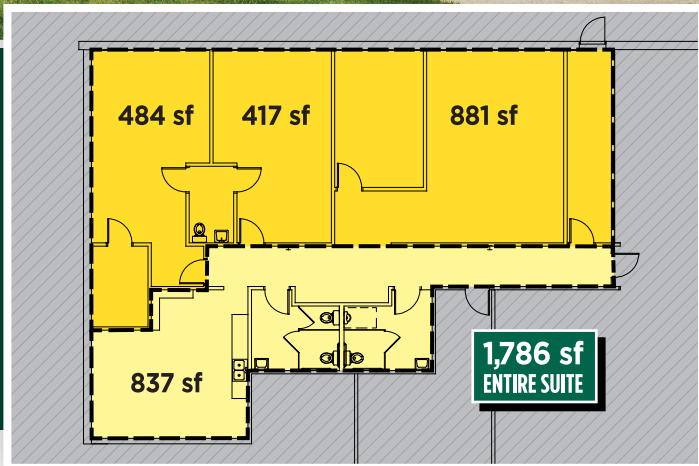

Have you just outgrown your office at your house? Green-Heart Business Park is an ideal location for new business development and more. Located in Boardman, Ohio the Business Park is located on Southern Blvd. and Mathews Road.

Rate includes CAM and Utilities and use of 837 SF of common area full kitchen and restrooms shared with one other Tenant.

SPECIFICATIONS:

- Climate Controlled
- Turn-Key Phone System
- Common Area includes Full-Size Kitchen and M/W Restrooms (Cleaned Weekly)
- Professional Entry Way
- Ample Free Parking
- Entry from Mathews Road
- Storage Space Available

Suite A 1783 SF Suite \$1200/mo.

OR

484 SF with storage room \$800/month

418 SF with private restroom \$700/month

881 SF with private office, workstations, and receptionist window

CONTACT:

John Angelilli – 330-502-6050
john@greenheartcompanies.com

